



Code

Single
package

Multiple
package

Min. ord.

Panic exit mortice locks

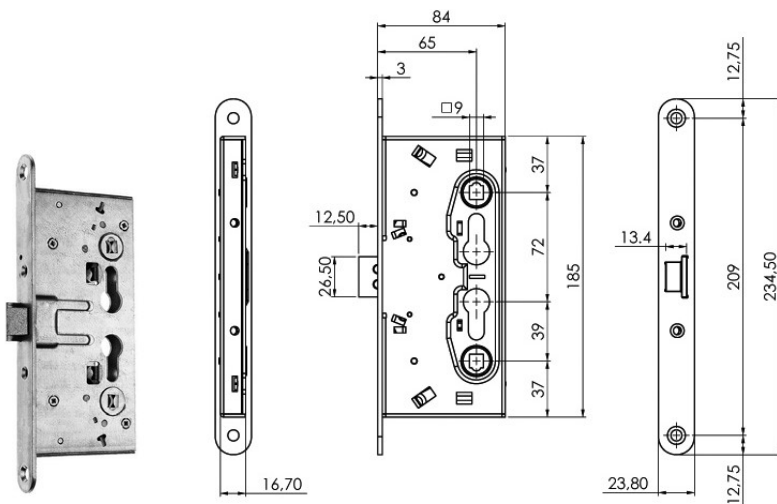

LOCK FOR LEFT- AND RIGHT- HANDED FIRE RESISTANT PANIC EXIT DOORS (EXTERNAL HANDLE). 1 lateral point, latchbolt only.

Internal: latchbolt operated by the panic exit device, by the handle or by the key.

External: latchbolt operated by the key and by the handle only if enabled by the key.

Front plate rounded, mm 24x3, zinc-plated. Panic exit two-piece follower mm 9. Distance mm 72. Backset mm 65.

9440000*0379, 9490000*0379, 94F0****379, 9449****5839 series panic exit bars.

Locking mechanism 94G0000**379.

Single packaging

214110654

1

10

10

Reversed latchbolt. Pull emergency door.

Single packaging

214110654.C

1

10

10

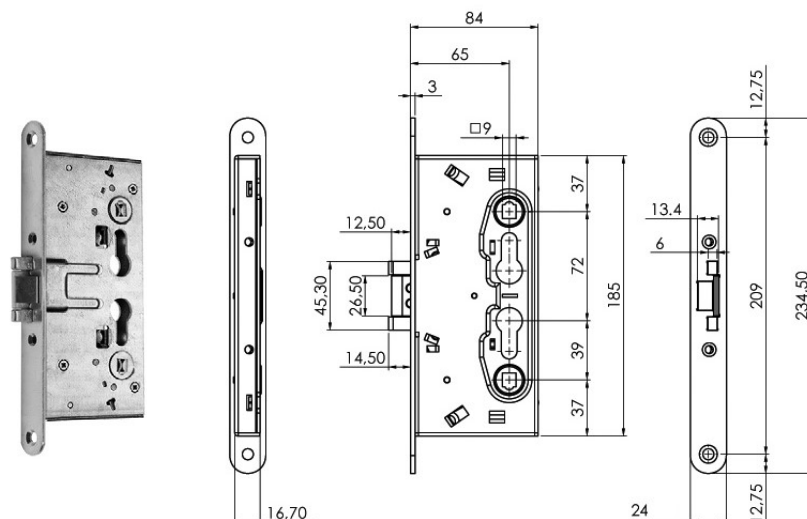

LOCK FOR LEFT- AND RIGHT-HANDED FIRE RESISTANT PANIC EXIT DOORS

(EXTERNAL FIXED KNOB). 1 lateral point, deadbolt and latchbolt.

Internal: deadbolt and latchbolt operated by the panic exit device, by the handle or by the key.

External: the key operates both the deadbolt and the latchbolt.

Front plate rounded, mm 24x3, zinc-plated. Panic exit one-piece follower mm 9. Distance mm 72. Backset mm 65.

9440000*0379, 9490000*0379, 94F0****379, 9449****5839 series panic exit bars..

Locking mechanism 94G0000**379.

Single packaging

214140654

1

10

10